

## Installation Instruction

### 1, Recessed

1, Remove the ceiling Gypsum board.

2, Connect the power cord.

3, Put through the panel light along ceilings diagonal

4, Fix the panel light to suitable place and power on.

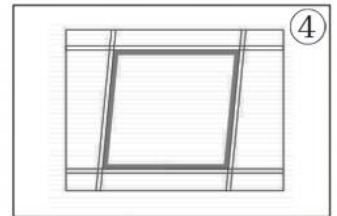
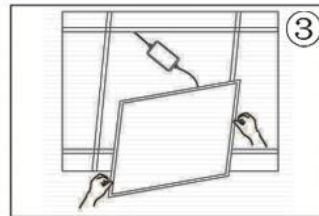
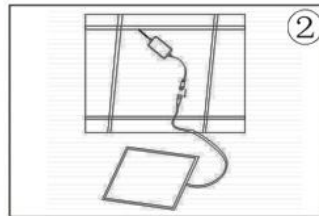
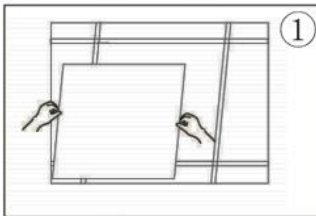

### 2, Spring

1, Fix four spring fasteners by screws to the panel light.

2, Pull up the spring, fasteners in vertical, then snap into the cut hole

3, Complete the installation.

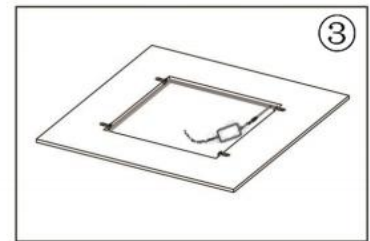
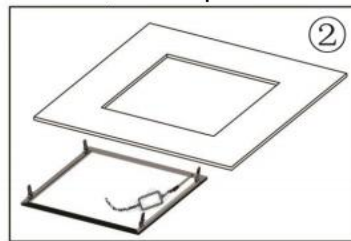

### 3, Suspending mounted

1, Remove the panel from the Package, then use the suspend rope, conditioner screwed into three hanging plates on the panel corner

2, A: Screwed the ceiling upper base out, use the screws with anchor to fix them on the ceiling.  
B: Screw the rope and ceiling hanging upper base which has been fixed.

3, A: Make the other end of rope conditioner.  
B: Connect the panel Terminal with the driver terminal by the waterproof connector

4, Light it

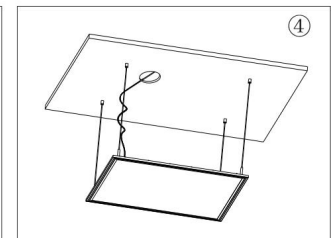
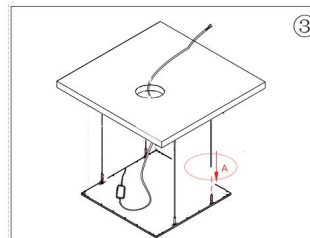
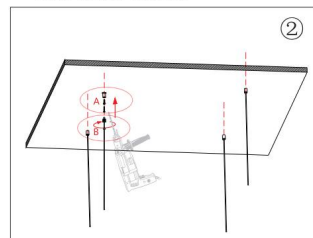
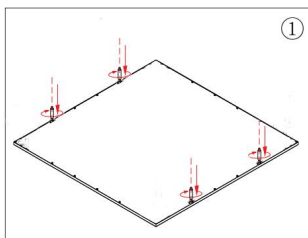

## Installation Instruction

### 4, Surface mounted

1, Put the panel frames out of the package, then fix three sides with screws.

2, Use the screws with anchor to fix the assembled frame on the ceiling.

3, A: Wiring from cable on the panel back.  
B: Then make the panel body slide into the frame.

4, Light it.

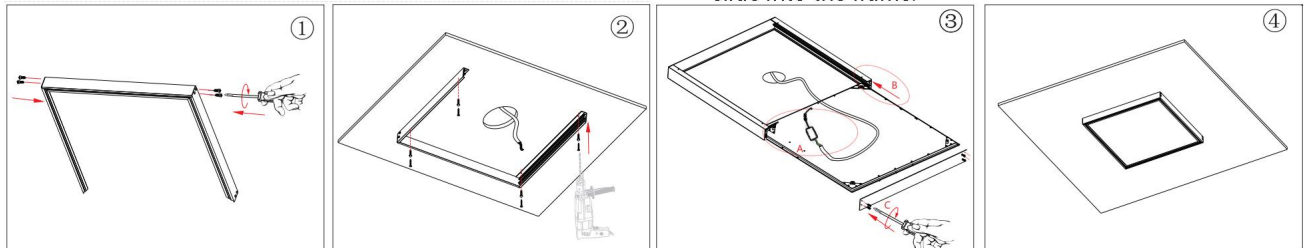

### 5, Clips mounted

1, Install the clip on the panel light body

2, insert to the ceiling

3, light it

