

Installation Instructions

ceiling

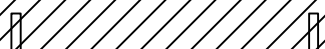

①

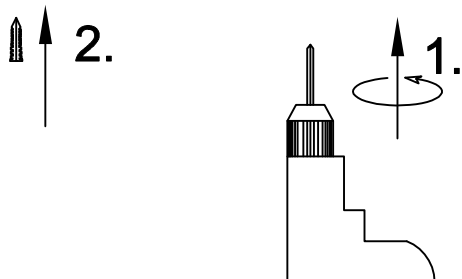

First of all, the lamp out, determine the installation position, and then use the drill hole and buried plastic house lizard.

ceiling



②

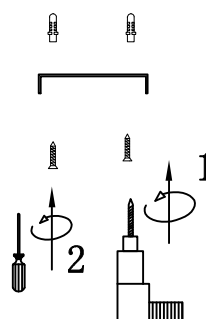

Second, the lamps and lanterns hanging plate fixed on the wall by the self tapping screws.

ceiling

③

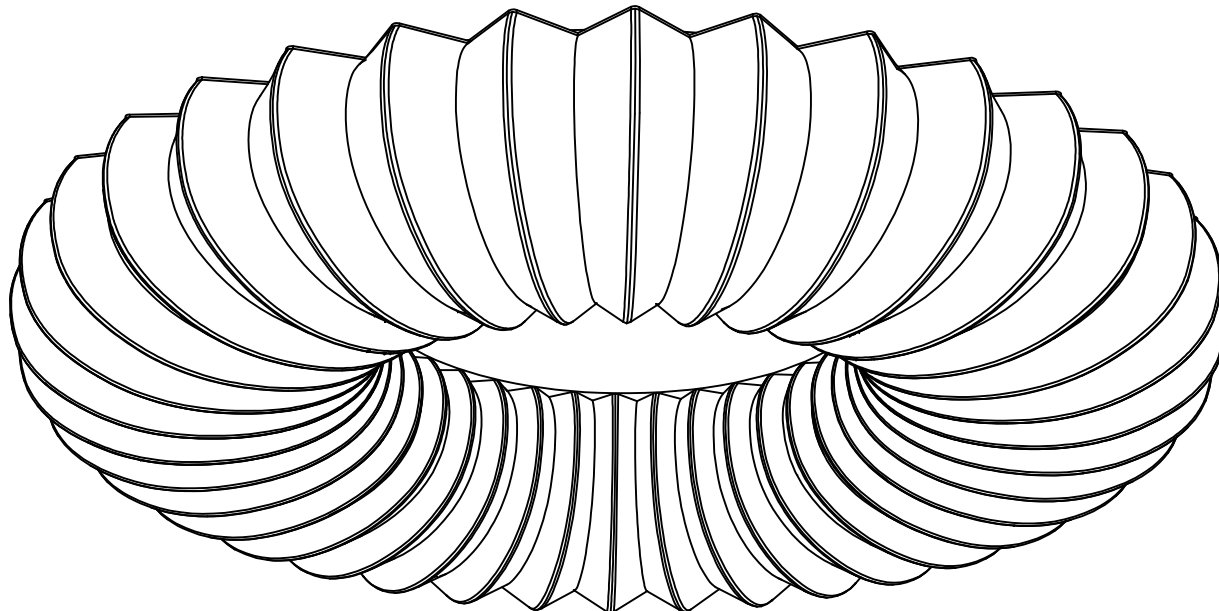
**Warning:**

1. Please wear gloves during the installation.
2. Do not install on ceiling which is damp or with wet limewater.
3. Cut off the electricity before installation in case of being shocked.



before getting through the electricity.

5. Do cut off the electricity before washing or repairing, and use the scour without causticity.

6. Please cut off the electricity and wait until the bulb gets cooling before replacing the bulb in case of being