

Installation Manual

Clips mounting

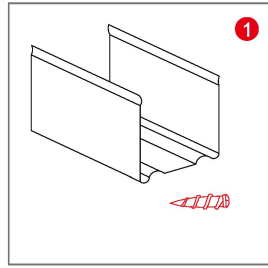

Stainless Steel Mounting Clips



Prepare for screws and clips

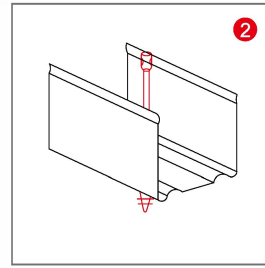

Drive the screw into the clips

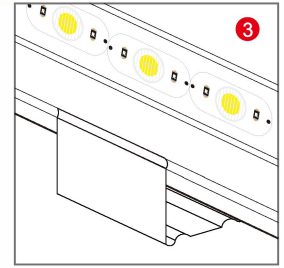

Put the light strip into the clip, Installed to complete

Aluminum chanel mounting



Aluminum Profile

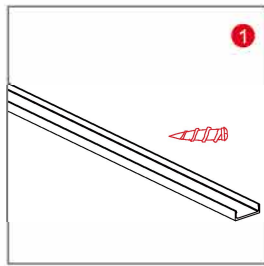

Prepare aluminum channel and screws

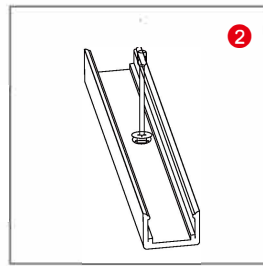

Drive the screw into the aluminum groove

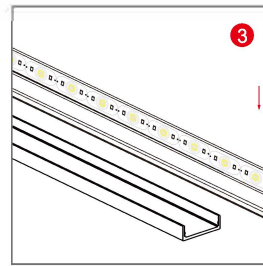

Put the light strip into the aluminum groove in the direction of the arrow

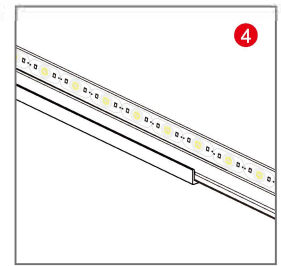

Installed to complete



Cautions

Correct operation

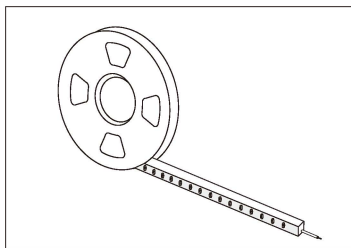

During the installation process, the LED wall washer is taken out from the reel naturally and keep it as straight as possible.

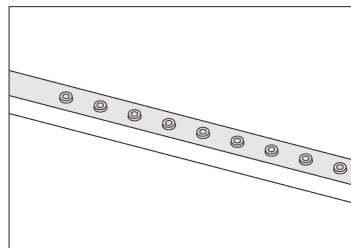

The LED wall washer should be kept vertical or horizontal during the installation process.

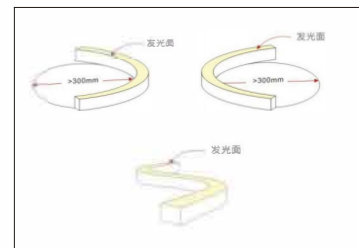

When install at the corner place, Keep it horizontal bend and bending art must be maintained $\varnothing > 300\text{mm}$.

Wrong operation

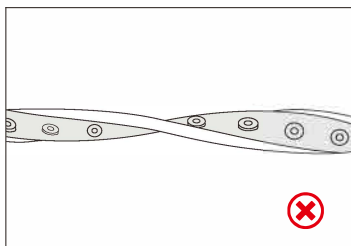

Do not twist the LED wall washer during the installation process.

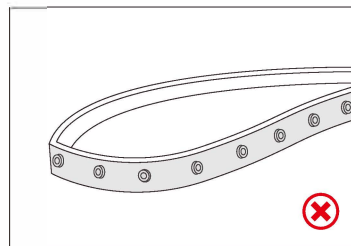

Do not fold the LED wall washer in half or bend it at a small angle during the installation.

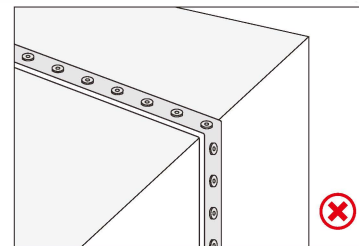

When the LED wall washer meets the corner during the installation process, the LED wall washer must be kept facing up and the back down, and it cannot be bent at right angles.