

Installation Manual

Installation

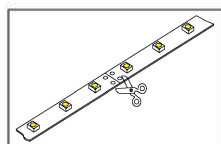

1. Cut in specific location

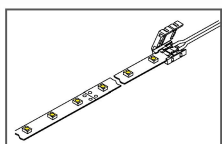

2. Put the PCB in the space between clip and connector, make the clips exactly aim at welding point

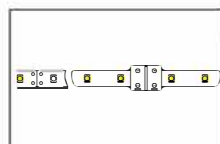

3. Close the cover of connector

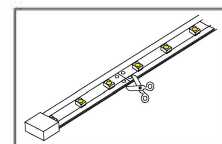

1. Cut in specific location

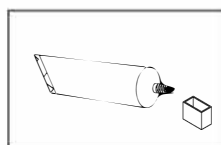

2. Infuse the gel in the end cap

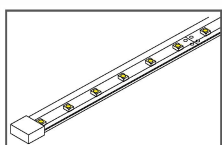

3. connect the end cap and wait for air drying

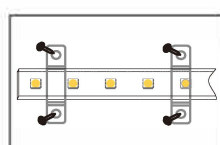

1. Install with clips

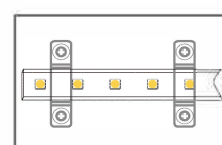

2. Fix with screws

1. STRIP TO STRIP INSTALLATIONS

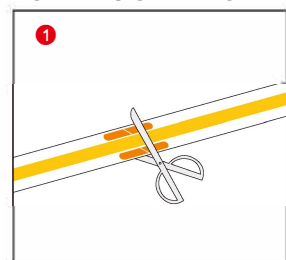

1. Cut the light strip from the cut point

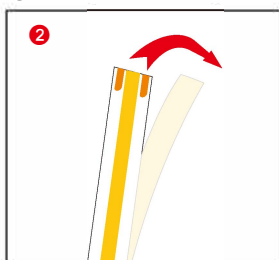

2. Tear off the 3M glue behind the light strip

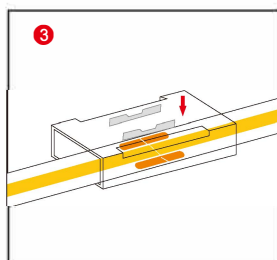

3. Put the COB light strip inside the crystal connector and press the iron piece down.

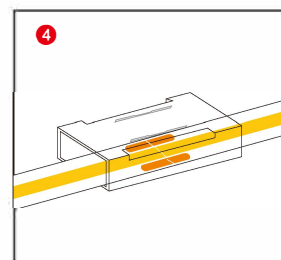

4. Test the light strip after pressing down the iron sheet, the installation is complete

2. STRIP TO WIRE INSTALLATIONS

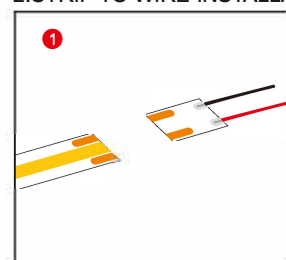

1. Prepare the dedicated cable for the crystal connector

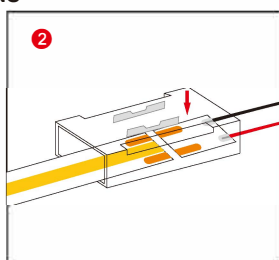

2. Put the light strip and cable into the crystal connector and press down the iron piece

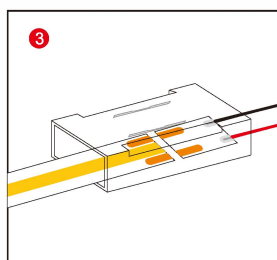

3. Installation is complete, test the light strip