

CORRAL LED HIGHBAY LIGHT

WARRANTY

The following circumstances will not receive replacement warranty:

- ① Damage caused, including, but not limited to, damage from abnormal working conditions, improper usage, storage that does not conform to the instruction manual;
- ② Dismantling, modification or improper installation or repairing of the products without Goldenlux's authorization;
- ③ Damages caused by environmental circumstances including, but not limited to, fire, flood, lightning strike, earthquake.

WARNING

To avoid the risk of fire, explosion, or electric shock:

This product should be installed, inspected, and maintained by a qualified electrician only, in accordance with all applicable electrical codes.

* Verify power wire is by following per under applicable electrical codes.

& The light source contained in this luminaire shall only be replaced by the manufacturer or his service agent or a similar qualified person.

& The external flexible cable or cord of this luminaire cannot be replaced; if the cord is damaged, the luminaire shall be destroyed.

To avoid electric shock:

- Be certain electrical power is OFF before and during installation and maintenance.
- Luminaires must be supplied by a wiring system suitable per local code with an equipment grounding conductor.

To avoid burning hands:

- Before to performing maintenance, ensure Luminaire is allowed to cool after poweing off for a period of 30 minutes.

To avoid product degradation:

- Do not operate in ambient temperatures above those indicated on the luminaire date sheet.
- Use proper supply wiring as specified on the luminaire date sheet.
- Avoid use in environments containing sulfur, chlorine or other halides, methyl acetate or ethyl acetate, cyanoacrylates, glycol ethers, formaldehyde, or butadiene.
- Mount luminaire no less than 36 inches from the ceiling.
- Make sure the supply voltage is within the voltage range stated on the date sheet.
- Use only replacement parts from GoldenLux.
- Aircraft grade mounting is recommended for dry locations only.
- Use only GoldenLux or equivalent parts for mounting luminaire.

MOUNTING

PENDANT EYEBOLT MOUNTING

STEP 1

Thread the enclosed eyebolt hook into the top of the luminaire housing, and tighten securely. Tighten the set screw to prevent the eyebolt from loosening.

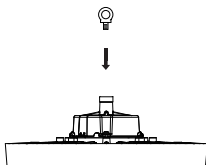

STEP 3

Refer to the Wiring Diagram to make electrical connections.

STEP 2

Use a chain, cable, mounting hook, or other mounting hardware to suspend the luminaire. Make sure the mounting hardware is securely attached to a stationary structure and strong enough to safely be attached to a stationary structure and strong enough to safely suspend the luminaire.

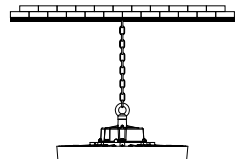

CEILING MOUNTING:

STEP 1

Punch M10 screw holes in the ceiling according to the bracket holes (as shown in Figure 6).

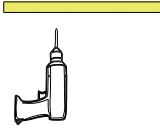

STEP 2

Align the bracket with the screw hole, tighten the screw and fix the bracket.

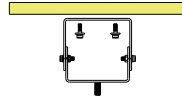

STEP 3

Align the hole at the top of the lamp with the bottom of the bracket, and tighten the screws to fix the lamp.

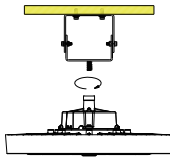

STEP 4

Tighten the screws at this position to complete the installation.

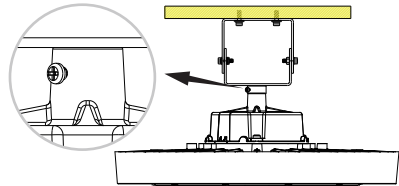

STEP 5

Unscrew the screw and adjust the lamp angle according to your needs Degree.

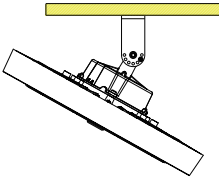

STEP 6

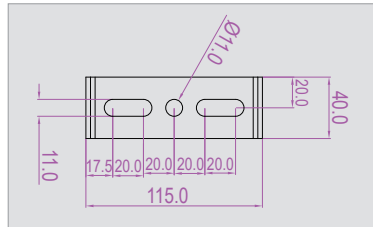

REFER TO THE WIRING DIAGRAM TO MAKE ELECTRICAL CONNECTIONS

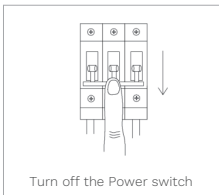

⚠ Connecting the cable requires an IP65 Tightness level

CE	AC-L (Brown)	AC-N (Blue)	AC-L (Yellow/Green)
UL	AC-L (Black)	AC-N (White)	AC-L (Green)

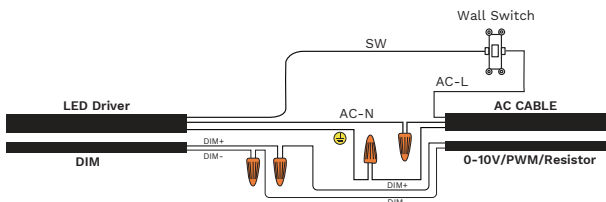

DIM	(DIM+) Purple	(DIM-) Pink
DIM	(DIM+) Brown	(DIM-) Blue