

Installation Manual

Installation

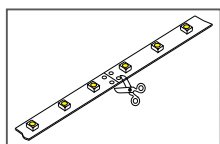

1. Cut in specific location

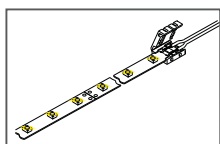

2. Put the PCB in the space between clip and connector, make the clips exactly aim at welding point

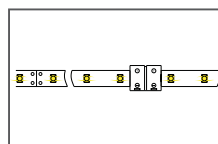

3. Close the cover of connector

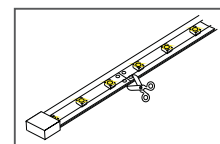

1. Cut in specific location

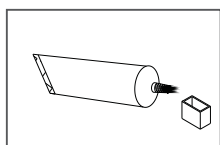

2. Infuse the gel in the end cap

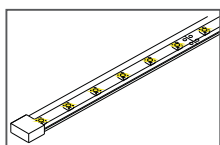

3. connect the end cap and wait for air drying

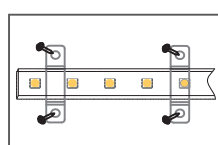

1. Install with clips

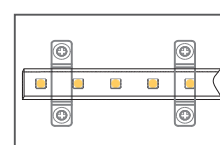

2. Fix with screws

1. STRIP TO STRIP INSTALLATIONS

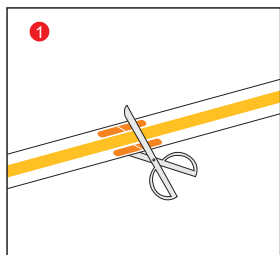

1. Cut the light strip from the cut point

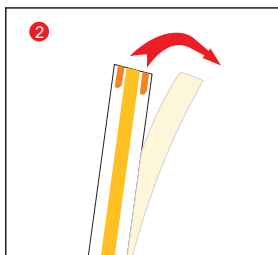

2. Tear off the 3M glue behind the light strip

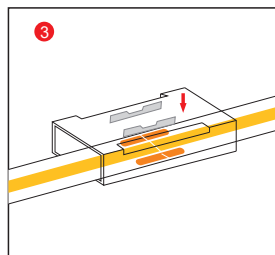

3. Put the COB light strip inside the crystal connector and press the iron piece down.

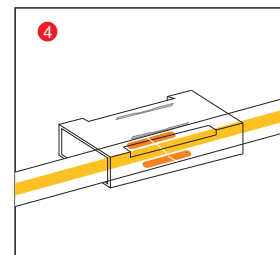

4. Test the light strip after pressing down the iron sheet, the installation is complete

2. STRIP TO WIRE INSTALLATIONS

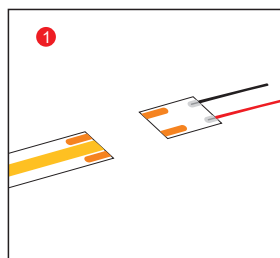

1. Prepare the dedicated cable for the crystal connector

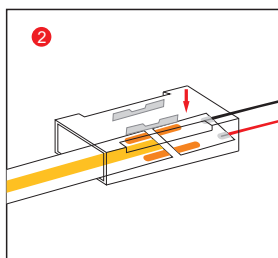

2. Put the light strip and cable into the crystal connector and press down the iron piece

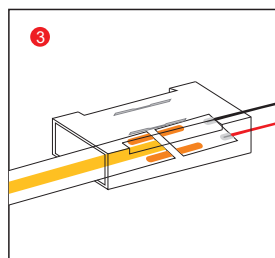

3. Installation is complete, test the light strip

Installation Manual

Cautions



When install the led strip, please note the installation technique. The led strip can be bent, but not distorted, as shown below.

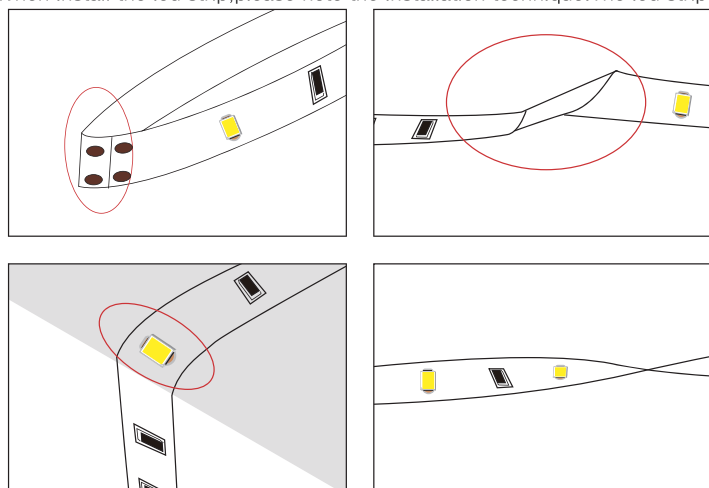

Distortion (Wrong)

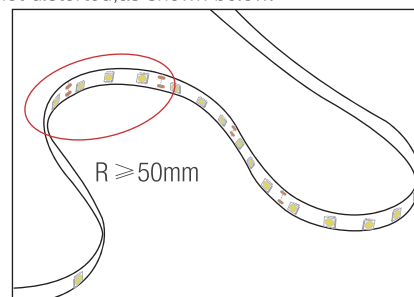

Bend (Right)

LED strips are low voltage products, you must use the power supply (transformer). Please don't connect the led strip directly to the AC 110v or AC 220v, otherwise it will burn out the LED strips.

Clean up the installation surface, it will ensure the reliability of the adhesive. The electrical connection process must be operated by a professional person.

Packing:

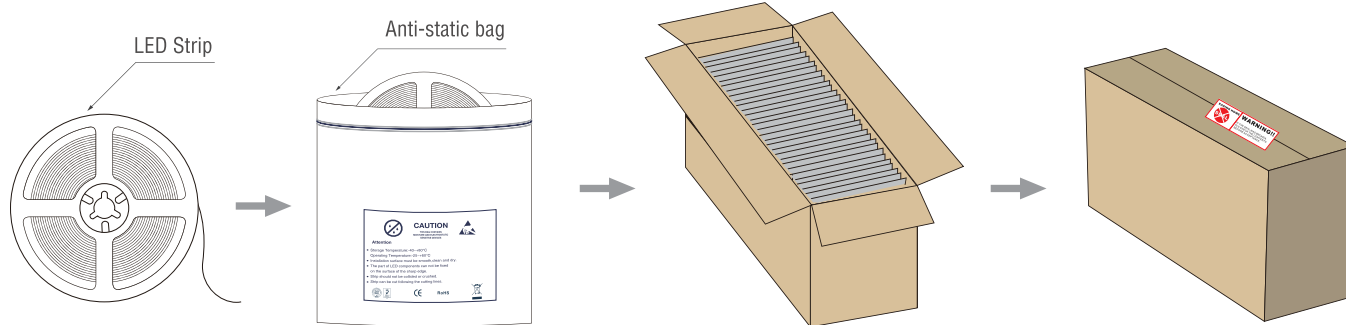

Notice:

- 1、 Please apply different IP rate products according to different environment conditions;
- 2、 Adopt suitable power supply to match the LED strips. Power is 20% bigger than max power of LED strips to ensure long time performance of power supply;
- 3、 Do not install it when power is on. Before powering on, please make sure the wiring is correct;
- 4、 Avoid privately changing or damaging the circuit or other component on the strip;
- 5、 Avoid scrape or bending during installation, it might be damaged with non repairable status;
- 6、 Strip linked in over long length would lead to problem of overload or uneven brightness;
- 7、 To protect your eyes, do not stare at the light for a long time while it's illuminated;
- 8、 Only professional personnel can install, dismantle and repair;
- 9、 Choose different connectors and controllers according to your different strip.