

Installation Instruction

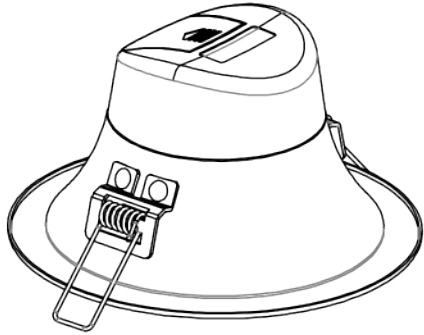

CAUTIONS :

1. Switch-off the power supply before any installation and maintenance operations.
2. Installaion should be carried out by a suitably qualified person in accordance with good electrical practice and the appropriate national wiring regulations.
3. Connect this lighting according to voltage and frequencies mention on driver.

INSTALLATION :

1 Make a hole

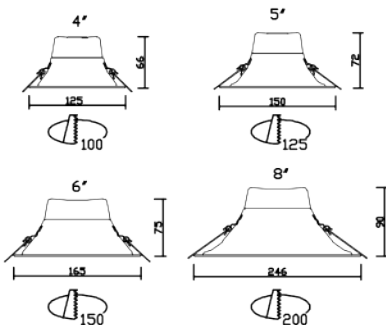
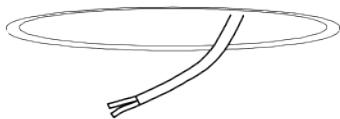

2

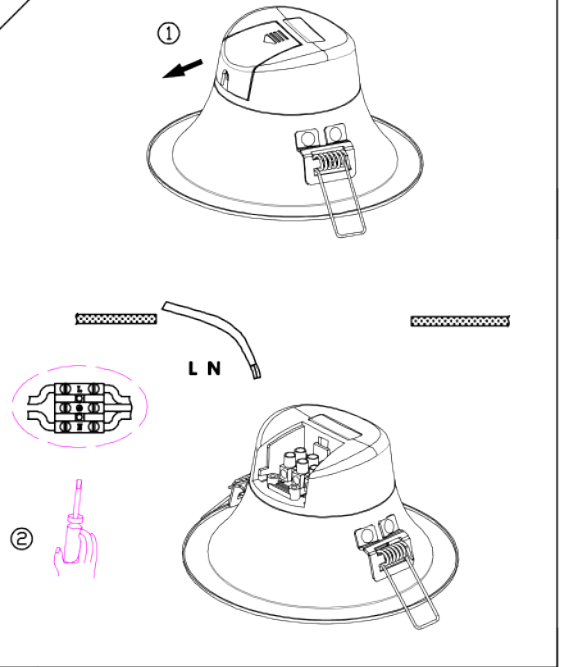

3

