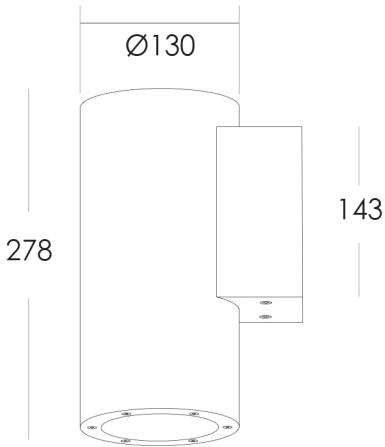
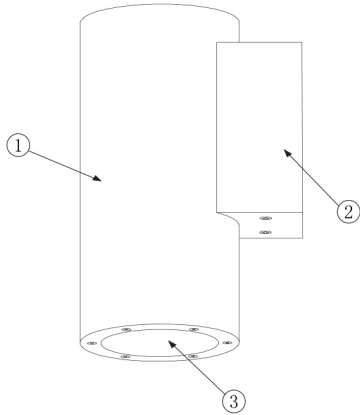

# LED WALL LIGHT

OUTLINE DIMENSION	BOM
 <p>Unit: mm</p>	 <p>① Housing ② Power base ③ PC cover</p>

Note: The drawing was show a general introduction to this description.  
When the discrepancy between the actual product and drawing,  
please all to the actual products.

## 1.FEATURES

- This product is a high power LED wall light.
- The standard color temperature of cool white is in range 5000k; warm white is in range 2700-3200k.
- The standard input voltage is 24VDC(low voltage),100-120V and 220-240V,totally 3 type.When you install the product ,please check the data label on the product and the wire.
- When installation, always work with technician or install by technician.
- The main material of this product is aluminum, surface coating is only suitable for natural environment ,don't install this product near the sea water or in the environment which is high salty or high acid.
- This is IP65 grade product, don't put fixture into water.
- Applicable environment temperature: -20℃<fixture<+40℃

## 2. INSTALLATION

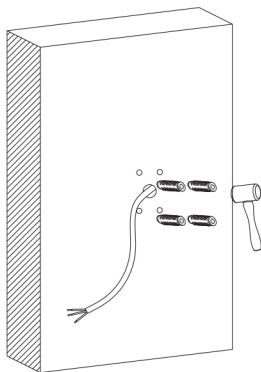

Drill two holes on the wall where you are about to install the lighting fixture. Then put two rubber plug into the holes respectively by using a hammer.

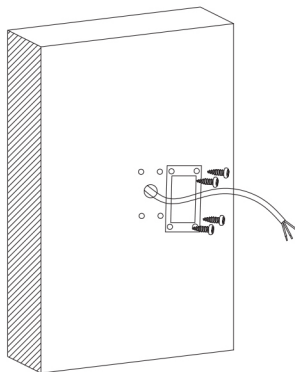

Fix the back cover of the bracket on the wall with two steel screw. Make sure the cable get through the hole in the middle of it.

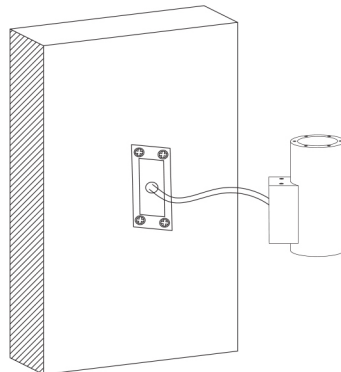

Connect the lighting fixture with the cable which is been prepared for the installation previously.

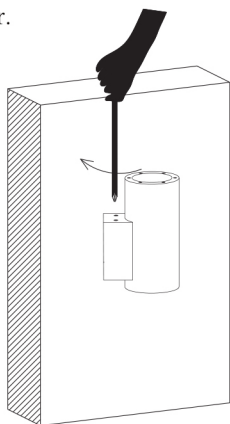

Fix the fixture on the back cover of the bracket with four screw.

## 3. WIRING DIAGRAM

3.1: Low voltage single color fitting: use external power supply, the input voltage of power supply must be consistent with the requested input voltage of the fitting, as the fitting is constant voltage input type. The power consumption of power supply must be decided by installer according to the requirements from the site.

Example of wiring:

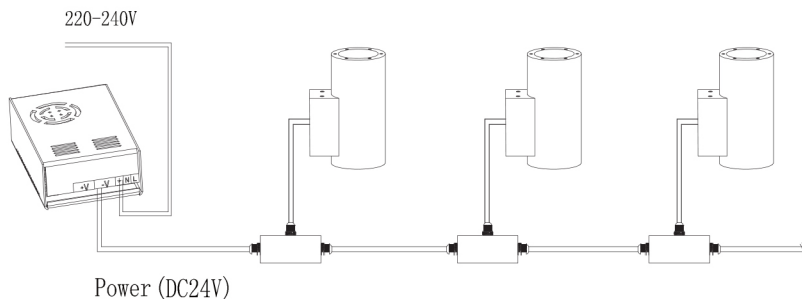

## 24VDC:circuit of product

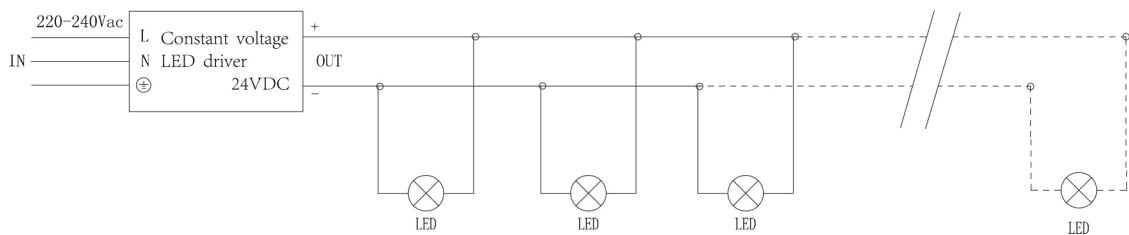

3.2:High voltage single color fitting: refer to the following recommended wiring method.

Example of wiring:

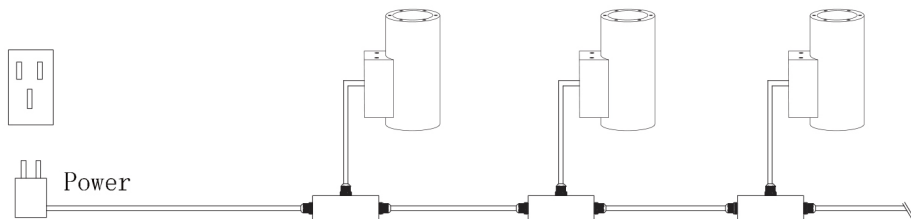

## 220-240Vac: circuit of product

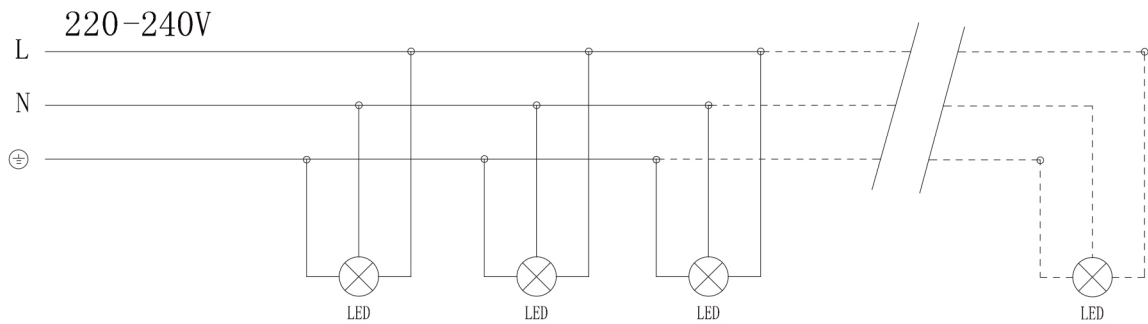

# 4.SPECIFICATIONS

### 4.1: Material specification.

- Housing: Extruded aluminum alloy #6063
- Painting: Powder coating, T=60-80um. /Adhesion of ISO
- Mounting base Material: class1/ASTM class 4B
- Painting: Die-casting aluminum
- Powder coating, T=60-80um. /Adhesion of ISO
- class1/ASTM class 4B
- UV-Resistance PC T=8mm
- Lens: Optical lens. efficiency ≥85%
- Light source: Citizen brand COB LED
- Operating temperature: -20℃ ~40℃

### 4.2: Electrical parameters:

Item NO.	Light source	Degree(° )	Input voltage(v)	Typical oprating current (mA)	Typical consumption (W)	Typical luminance(lm)
15408	1×25W COB	12° /24°	24VDC 120/240	24V=1080 120V=270 240V=146	24V=26 120V=30 240V=31	Cool white=2263 Warm white=2185